

Decal Application Instructions

Center Hinge Method

Your graphics will come like this.

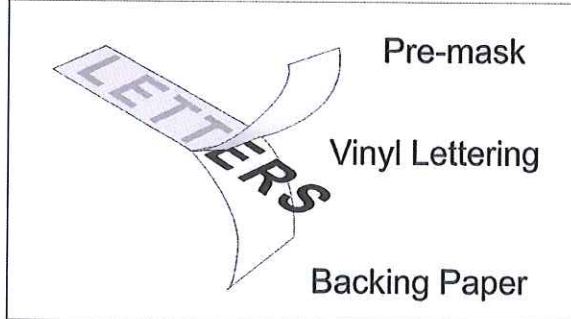

1. Clean surface with isopropyl alcohol or light soapy water. Do not use window cleaners.

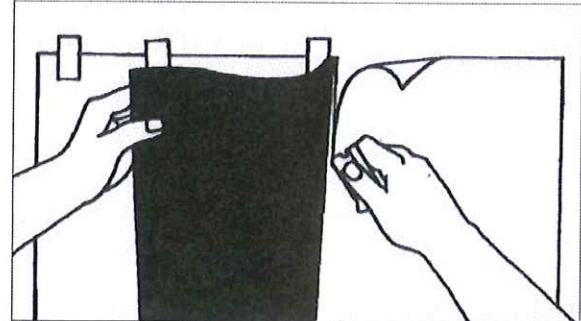

4. Fold half of graphic back over hinge. Peel liner back and cut off close to hinge.

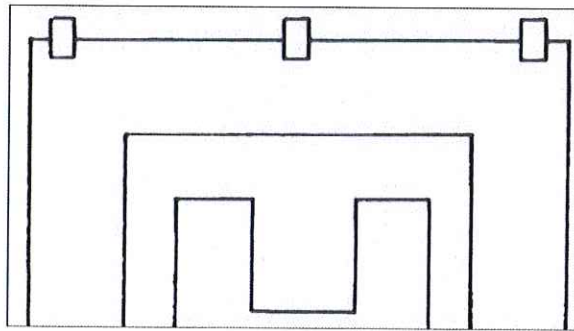

2. Tape graphic in position with pieces of masking tape. Measure and place graphic where desired.

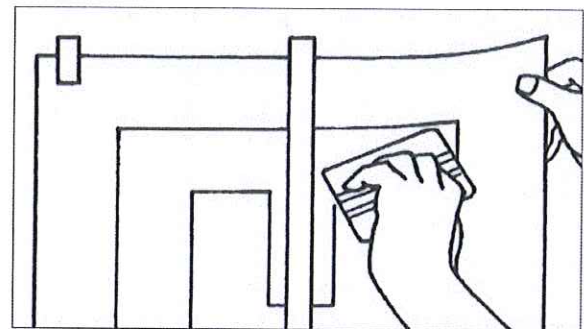

5. Fold back and squeegee graphic to surface beginning at center of tape and working outward using firm overlapping strokes. Hold graphic away from surface and do not allow graphic to touch until pressure is applied.

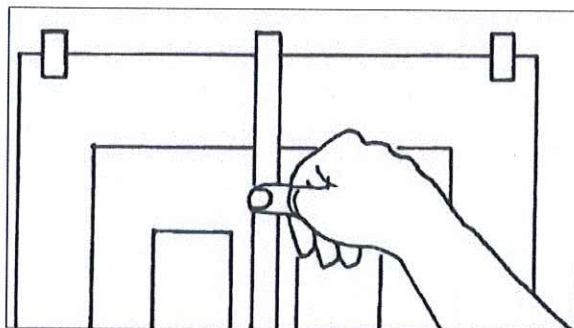

3. Apply a tape hinge vertically through center of decal and onto substrate / vehicle

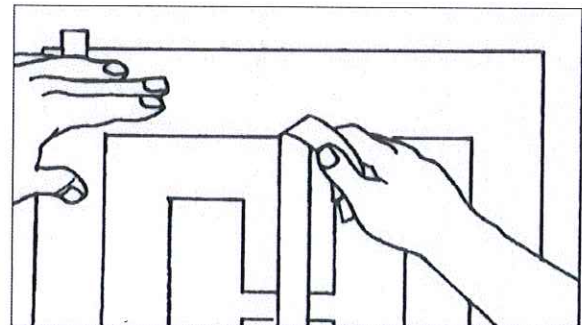

6. Remove hinge and premask.

BIG IMAGES. BIG IDEAS. MAKING BRANDS MOVE.